

Deed.

Mary A. Preston

TO

Elijah D. Sizer

Dated April 23. 1887

For 145 acres of land
in warrant no.
1193, Portage Twp.

Consideration paid \$3000

Acknowledged April 23. 1887

Recorded May 3. 1887.

This Indenture, MADE THE *twenty third* day of *April* in the year of our Lord one thousand eight hundred and *eighty seven*.

Between *Mary A. Preston of Freeland, Montgomery County and State of Pennsylvania* of the first part and *Elijah D. Sizer of Sizerville, Cameron County and State of Pennsylvania* of the second part.

Witnesseth, That the said *parties* of the first part, for and in consideration of the sum of *three thousand* Dollars lawful money of the United States of America, unto *her* well and truly paid by the said party of the second part of and before the selling and delivery of these presents, the receipt of *which* is hereby acknowledged *has* granted, bargained, sold, aliened, released, conveyed, and confirmed, and by these presents do *ok* grant, bargain, sell, alien, release, convey, and confirm, unto the said party of the second part, *his* heirs and assigns, **ALL that certain piece or parcel of land** *situate in Portage township, Cameron County and State of Pennsylvania, bounded and described as*

follows, viz: Beginning at post corner being the northeast corner of warrant no. 1193. Running thence south sixty seven 67° degrees west, seventy two (72) rods to a post corner on east line of Cemetery lot, thence south twenty eight (28°) degrees east, one and six tenth (1.6) rods to a post corner, being the south-east corner of the cemetery lot; thence south sixty five (65°) degrees west, twenty (20) rods to a post in center of public road; thence south nineteen (19°) degrees east three and six tenths (3.6) rods, to a post corner, thence south fifty three (53°) degrees west, ninety and one half (90.5) rods to a stone corner; thence south twenty five (25°) degrees east, one hundred and twenty seven (127) rods to a post corner; thence east one hundred

(100) rods to a hemlock corner on the east line of warrant no. 1193; thence north on a warrant line about two hundred and ten (210) rods to place of beginning, containing one hundred and fort five acres (145) be the same more or less, and being a part of warrant No. 1193 and being land conveyed by will of Jared T. Preston to his wife Mary A. Preston which will is needed in Book A page 256 in the Recorders office at Emporium, Cameron County, and State of Pennsylvania.

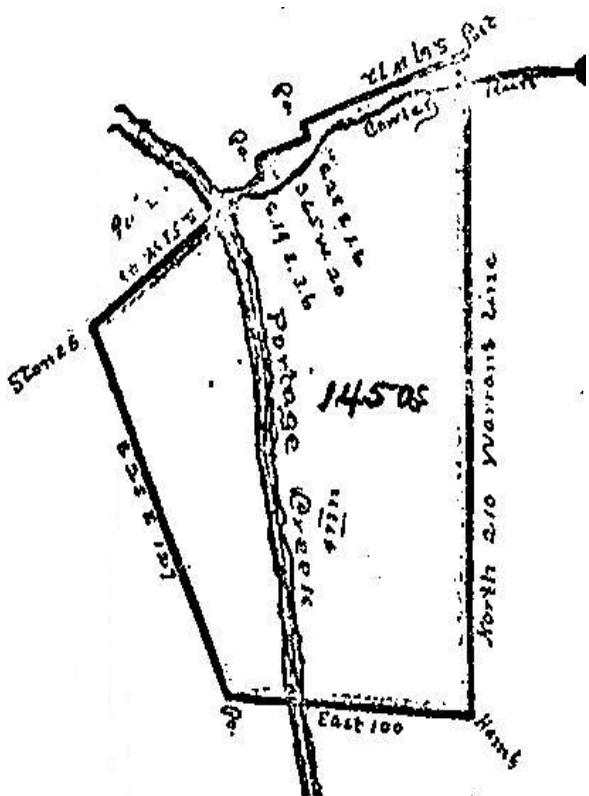

Together with all and singular the tentaments, hereditaments and appurtenances to the same belonging, or in any wise appertaining of the reversion and reversions, remainder and remainders, rents, issues and profits thereof; **AND ALSO,** all the estate, right, title, interest, property, claim and demand whatsoever, both in law and equity, of the said party of the first part of, in, to, or out of the said premises and every part and parcel thereof:

